



Indicative layout of proposed Athy Distributor Road which does not form part of this project. It is shown here for reference only

Cycle lane to terminate here. Extension past this location to be considered as part of the design for Athy Distributor Road junction with Fortbarrington Road

Cyclists traveling north can merge into proposed cycle lane

Signal controlled pedestrian crossing

Proposed footpath to tie into existing footpath and kerb line.

- General Notes:
- (i) Hard copies, dwf and pdf will form a controlled issue of the drawing. All other formats (dwg etc.) are deemed to be an uncontrolled issue and any work carried out based on these files is at the recipient's own risk. RPS will not accept any responsibility for any errors from the use of these files, either by human error by the recipient, listing of the un-dimensioned measurements, compatibility with the recipient's software, and any errors arising when these files are used to aid the recipient's drawing production, or setting out on site.
  - (ii) DO NOT SCALE, use figured dimensions only.
  - (iii) This drawing is the property of RPS, it is a project confidential classified document. It must not be copied used or its contents divulged without prior written consent. The needs and expectations of client and RPS must be considered when working with this drawing.
  - (iv) Information including topographical survey, geotechnical investigation and utility detail used in the design have been provided by others.
  - (v) All Levels refer to Ordnance Survey Datum, Main Head.
- Pavement Specification:
1. Surface Course - Section 5 of Series 900 - SMA 10 / Surf/ PMB 65/105-60 - 40mm.
  2. Binder Course - Section 3 of Series 900 - AC 20 dense bin 40/60 - 60mm.
  3. Sub-base - 804 - Granular Material Type B - 150mm.
  4. Capping - 6F2 - 450mm (600mm if CBR<4% 300mm Min if CBR>4%).
- General Notes:
1. Precast concrete kerbs to be as detailed to CC-SCD-01101 (RCD/1100/1).
  2. Dropped kerbs at pedestrian crossings and pedestrian accesses are to be provided. At pedestrian crossings, the kerbs at dished crossing points are to be laid flush to the carriageway, or to a maximum upstand of 6mm.
  3. At crossings at the entry ramps, the crossing is to ramp down to the entry ramp level and be flush with the level of the entry ramp.
  4. Where the provision of kerbing starts or terminates along the road, the kerbing shall be ramped up to the required height at a desirable slope of 1:20, or a maximum slope of 1:12.
  5. Concrete at footways shall be in accordance with Clause 1106 of TII Specification for Roadworks Series 1100, CC-SPW-01100. Concrete footways to receive a non-skid brush finish to the surface. The provision of tactile paving shall be buff coloured at uncontrolled crossing points as per requirements of the Traffic Management Guidelines.
  7. The dimples on the tactile paving units shall be aligned so as to guide visually impaired pedestrians directly across to the other side of the road, where the corresponding crossing point is located.
  8. All traffic signage and line marking shall be in accordance with the Traffic Signs Manual.
  9. Cycle lane design and layout shall be in accordance with the National Cycle Manual.

S:\MGC0712 - NDFA\_SHB3\MGC0712-04 - Athy\8.0 Drawings\KP\KP001 - Traffic Engineering Layout.dwg

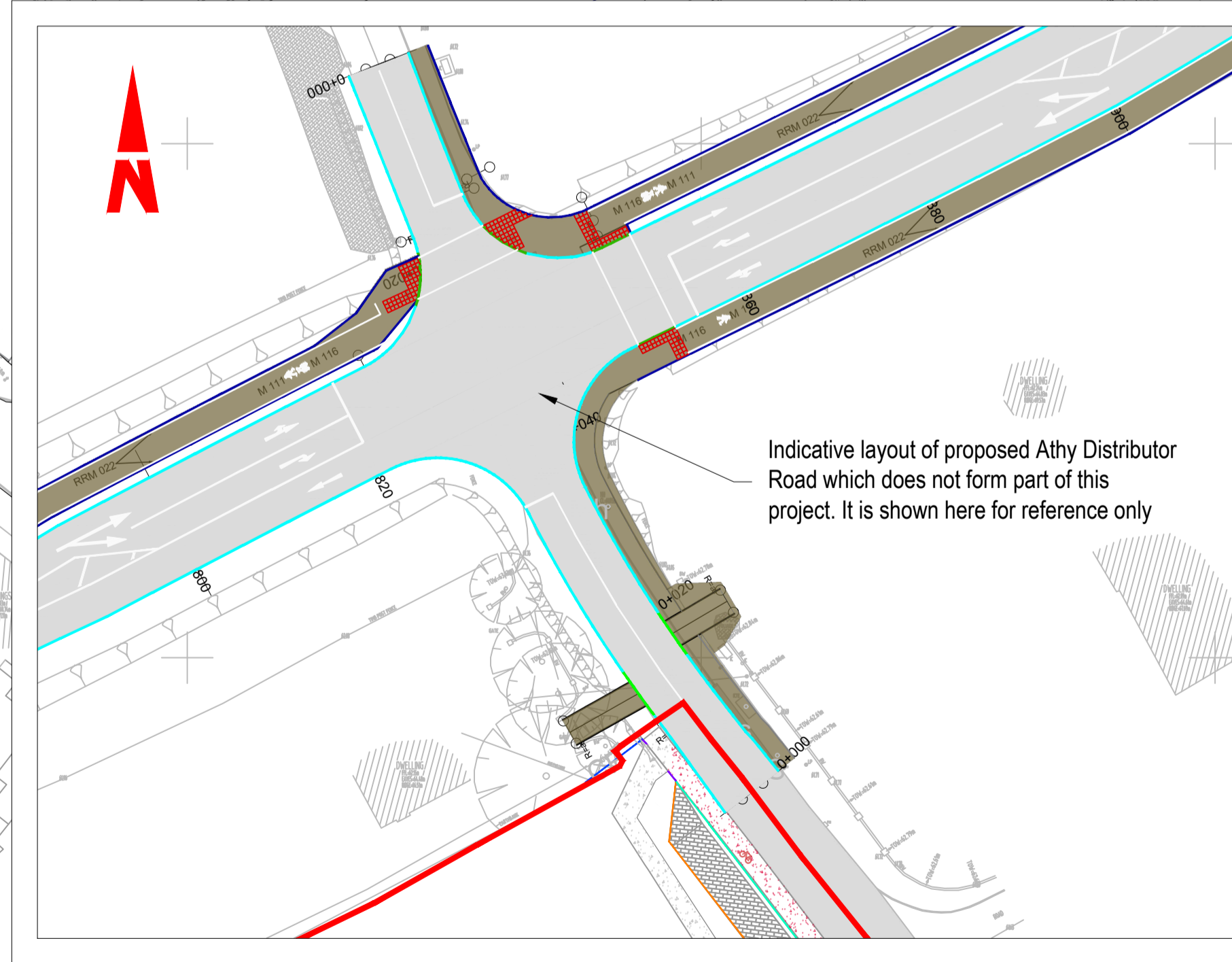
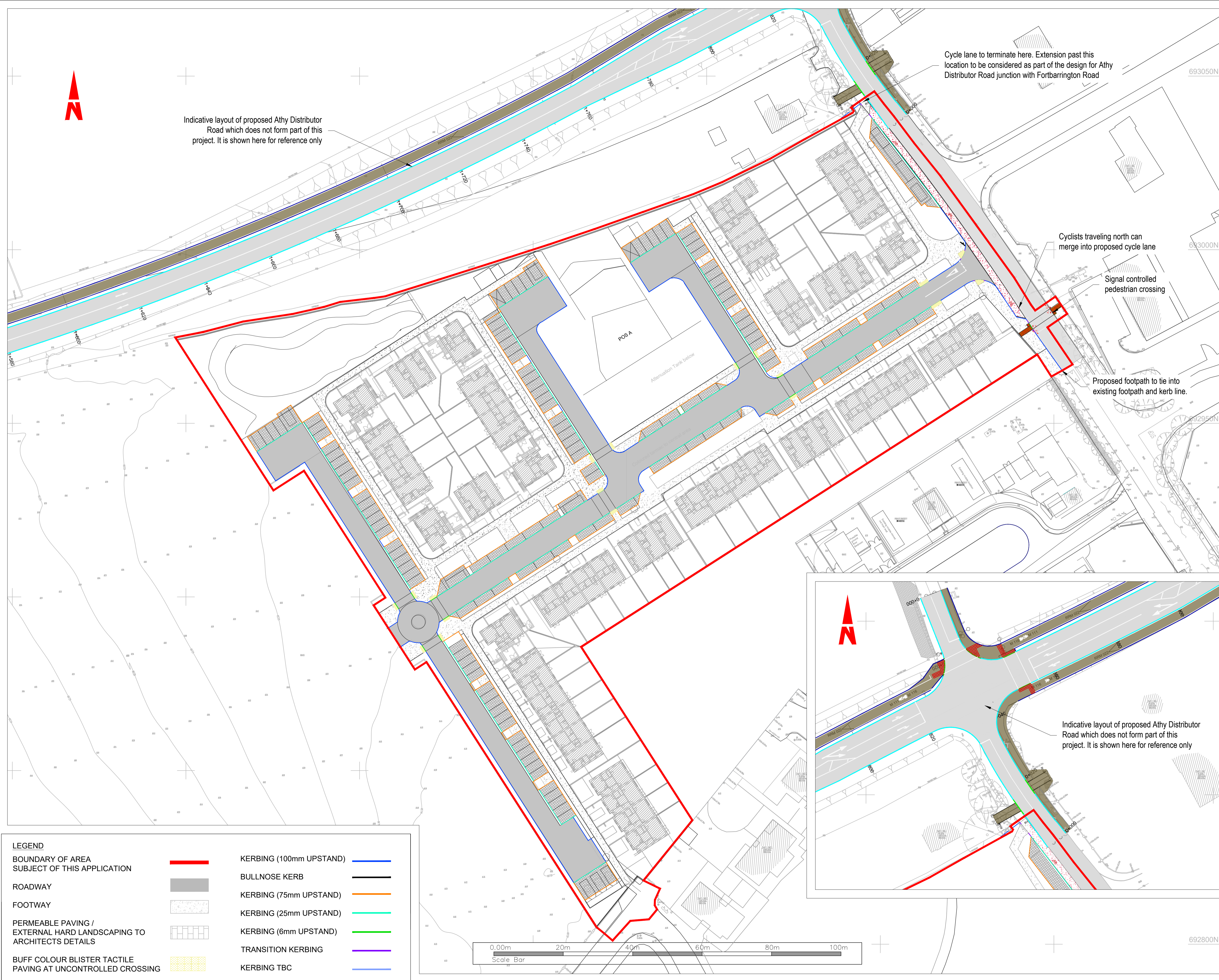

LEGEND	
BOUNDARY OF AREA SUBJECT OF THIS APPLICATION	KERBING (100mm UPSTAND)
ROADWAY	BULLNOSE KERB
FOOTWAY	KERBING (75mm UPSTAND)
PERMEABLE PAVING / EXTERNAL HARD LANDSCAPING TO ARCHITECTS DETAILS	KERBING (25mm UPSTAND)
BUFF COLOUR BLISTER TACTILE PAVING AT UNCONTROLLED CROSSING	KERBING (6mm UPSTAND)
	TRANSITION KERBING
	KERBING TBC

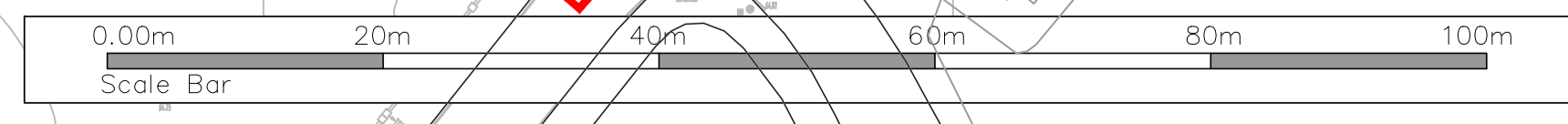

Rev	Date	Chk	Amendment / Issue	App
P05	24.11.21	OK	Issue For planning	OK
P04	19.11.21	OK	Issue for LA Review	OK
P03	21.09.21	OK	Issue for LA Review	OK
P02	15.09.21	OK	Issue for Review	OK



Lyrr 2, IDA Business & Technology Park, Mervue, Galway  
 T +353 91 400200  
 W www.rpsgroup.com/ireland  
 E ireland@rpsgroup.com

Project: SHB 3  
 ATHY, CO. KILDARE

Title: Traffic Engineering Layout

Model File Identifier: SHB3-ATY-CS-RPS-DR-KP001

File Identifier: SHB3-ATY-CS-RPS-DR-KP001-01

Created on: July 2021  
 Sheets: 01 of 01

Scale: 1:500 @ A1  
 1:1000 @ A3  
 Status: S4  
 Rev: P05